

Youte Oil Drain Plug Catalogue



SUMP PLUG

090-030

Single Oversized Machine
1/2" - 20 Drain Plug
3/4" Hex Head



090-031

Double Oversized Machine
1/2" - 20 Drain Plug
3/4" Hex Head



090-032

Triple Oversized Machined
1/2" - 20 Drain Plug
3/4" Hex Head



090-092

1/2" Drain Plug Plain Finish
Square Counter Sunk Pipe Plug



090-058

Chrysler: 6034376

Plain with Rubber
Washer Face Gasket
Thread: 1/2"-20
Hex: 5/8"



090-081

Oil Drain Plug
Oversize M12-1.75
S.O.,
Head Size 15mm



090-005

(FORD: 8HA 6730)

Oil Drain Plug Standard

Thread: 1/2"-20

Hex: 7/8"

AMERICAN MOTORS: 3224097

FORD MOTOR COMPANY: D1AZ 6730-B

NAVISTAR: IHC-090-005-B

CHRYSLER: J3224097

Application Summary:

American Motors Corporation (AMC) 1988-64

Ford Motor Company 1996-54

Navistar 1980-68



090-052

(GM: 3921988)

Thread: 1/2"-20

Fits the following applications:

Buick: 4, 6 & 8 Cylinder All [Exc. 2.5(151)

3.0, 4.3, 4.9 (301 Eng.)] 59-On

Cadillac: 6 & 8 Cylinder All (Exc. 4.1 Eng) 66-On

Chevrolet (Inc. GMC Light Truck): 4, 6 & 8 Cylinder All

[Exc. 1.8 (diesel), 2.5 (151), 4.3 (diesel) Eng.] 28-On

Oldsmobile: 4, 6 & 8 Cylinder All [Exc. 1.8 (diesel), 2.5

(151), 3.0, 4.3, (diesel), 4.3S, 4.9T (301)Eng.] 61-On

Pontiac: 4, 6 & 8 Cylinder All [Exc. 1.8 (diesel), 2.5

(151), 4.3 (diesel), 4.3S, 4.9T (301)Eng.] 60-On



SUMP PLUG

029-589



Zinc
Zinc
Thread M12-1.25
Fits the following applications:
Nissan: Sentra, Stanza
& Pulsar with FWD 1982-On

090-038



(NISSAN: 11128-01M0B)
Zinc & Yellow
12mm - 1.25 Drain Plug
14mm Hex Head
Fits the following applications:
SUZUKI (09247-12101)
TOYOTA (90341-12012)

090-049



(GM:94842686)
Thread: M12-1.25
Hex: 14mm
Fits the following applications:
Nissan (11128-01M05)

090-060



(GM:2421-3991)
(GM:21006725)
Zinc
M12-1.75
Hex: 14mm
With Rubber Gasket
Fits the following application:

090-059



(FORD:F5RZ 6730-B)
Plain With Rubber
Washer Face Gasket
Thread: M12-1.75
Hex: 15mm
Fits the following applications:
Ford: 2.5, 3.0 & 4.6 Eng
. with Modular & Aluminum Pans

090-156



(ISUZU:8-11519-408-0)
(GM:11519408)
(JAGUAR:XR8 20128)
(FORD :YS4Z 6730-AA)
12mm - 1.75 Drain Plug
13mm Hex Head
With Inset Rubber Gasket
Replaces Ford O.E. #YS4Z-6730-AA
Fits the following applications:
Ford 1999 - 93

090-091



(GM:11518377)
(ISUZU:8-11518-377-0)
12mm x 1.75 Premium (Magnetic)
13mm Hex Head
With Inset Rubber Gasket
General Motors 2017-16
Isuzu 2008-96

090-034



(CHRYSLER:J8132293)
(GM:10017615)
(ISUZU:8-10017-615-0)
Thread: M12-1.75 Hex: 15mm
Fits the following M12-1.75 applications:
Buick: 4 Cylinder 151 (2.5) Eng. 80-On
6 Cylinder 3.0, 4.3 (Diesel) Eng. 82-On
8 Cylinder 4.3, 4.9 Eng. 81-77
Cadillac: 8 Cylinder 4.1 Eng. 82-On
Chevrolet: 4 Cylinder 151 (2.5) Eng. 78-On
6 Cylinder 4.3 (Diesel) Eng. 82-On
Oldsmobile: 4 Cylinder 151 (2.5) Eng. 78-On
6 Cylinder 3.0, 4.3 (Diesel) Eng. 82-On
8 Cylinder 4.3S, 4.9T (301) Eng. 80-79
Pontiac: 4 Cylinder 151 (2.5) Eng. 77-On
6 Cylinder 4.3 (Diesel) Eng. 82-On
8 Cylinder 4.3S, 4.9T (301) Eng. 81-77

SUMP PLUG

090-153



(Ford :XW4Z-6730-BA)

12mm - 1.75 Drain Plug

Rubber Molded Around Washer Face

15mm Hex Head

1W4Z 6730-BA:

FORD

AJ0310404: MAZDA

Ford 2012-99

Lincoln 2012-06

090-079



(GM: 3536964, 3538469,11519408,

11562588, 24100042;

Isuzu: 8-11519-408-0)

Zinc with Rubber Gasket

Thread: M12-1.75

Hex: 15mm

Fits the following applications:

GM: 2.2 (4),3.1 (M), 3.8 (K), 3.8 (1), 2.3, 4.9 & 6.0L

Eng. 1985 - On

090-206



(F81Z-6730-AA)

Plain with Rubber

Washer Face Gasket

Thread: M10-1.5

Hex: 13mm

Fits the following 4R100 transmission applications:

Ford: E150-450, F150-450 Excursion &

Expedition 1980 - On

090-076



Zinc

Thread: M14-1.25

Hex: 13mm

Length Under Head: 16mm

Washer Head O.D.: 23mm

Fits the following applications:

Jeep

090-033



(Honda: 90009-PH1-000)

Zinc & Yellow

Thread: M14-1.5

Hex: 17mm

Fits the following applications:

Acura & Honda

090-169



(N90288901)

Black Zinc

Thread: M14-1.5

Hex: 19mm

Fits the following applications:

Volkswagen

090-098



(CHRYSLER:6503433)

Plain with Rubber

Washer Face Gasket

Thread: M14-1.50

Hex: 17mm

Rubber Gasket O.D.: 28mm

Fits the following applications:

Chrysler 1.5 & 2.0 Eng.

SUMP PLUG

090-098



(CHRYSLER: 6504018)

Plain with Rubber

Thread: M14-1.50 Hex: 13mm

Fits the following applications:

Chrysler 2.0, 2.4, 2.7, 3.2, 3.5,

3.7 & 4.7 Eng. 2000 - On

Chrysler 2003-95, Mitsubishi 1997-9

, Nissan 2019-16

NISSAN: 11128-EZ40A

MITSUBISHI: M06503433

090-171



(N90813201)

Zinc with Sems ® Gasket

Thread: M14-1.5

Hex: 19mm

Fits the following applications:

Audi Cabriolet & Quattro with 1.8, 1

2.0, 2.7, 2.8, & 3.0 Eng.

VW Beetle, Eurovan, Golf, Jetta,

Passat & Touareg with 1.8, 1.9,

2.0, 2.8, 3.2 & 4.0 Eng.

090-161



19773

(F75Z-6730-BA)

Phosphate with

Rubber Gasket

Thread: M14-1.5

Hex: 16mm

Fits the following applications:

Ford Vans & Trucks with 6.8L Eng.

2000-96

052-30



(E9DZ-6730-B)

Zinc

Thread: M14-1.5

Hex 13mm

Fits the following applications:

Ford: Escort

090-164



(CHRYSLER: 5073945AA)

Thread: M14-1.5 Hex: 13 mm

Fits the following applications:

Mercedes: 300 Series

MERCEDES-BENZ: 6019970230

MERCEDES-BENZ: 111 997 03 3

SUZUKI: 1151863J01

011-354



(6507741-AA)

Zinc with

Rubber Gasket

Thread: M14-1.5

Hex: 13mm

Washer Head O.D.: 29mm

Fits the following application:

Chrysler

090-033



20426

(90009-PY3-000)

Zinc & Yellow

with Aluminum Gasket

Thread: M14-1.5

Hex: 17mm

Length Under Head: 15mm

Washer Head O.D.: 24mm

Fits the following applications:

090-162



Zinc

with Rubber Gasket

Saturn # 90502556

14mm - 1.50 Drain Plug

With O-Ring - Zinc Palte

For Cadillac Catera.

090-036



14mm - 1.50 Drain Plug

Reg Point Magnetic

SUMP PLUG

090-115



(Ford:F6TZ-6730BA)

Phosphate with
Rubber Gasket
Thread M14-1.50
Hex: 13mm

Fits the following applications:

Chrysler: with 2.0(F), 2.4(B,G,8), 2.7(R,T),
3.3(G,S,3)& 3.5(G,4) Eng. 2000 - On

Ford: Aerostar, Explorer & Ranger 6 4 Ltr.
Cylinder Eng. 1996-On

(BRITISH LEYLAND:1013938)

(CHRYSLER:6506214AA)

(VOLKSWAGEN:7B0103193)

(JAGUAR:AJ83017)

(MAZDA:LF1310404)

090-053



Thread: M14-1.5 Zinc

Hex: 16mm

Fits the following M14-1.5 applications:

AMC: 4 Cylinder VW 121 Eng. 79-77

Chevrolet: 4 Cylinder 1.8 (Diesel) Eng. 81-On

Chrysler Corp. (Exc. Imports): 4 Cylinder All 78-On

Chrysler Corp. Imports: 4 Cylinder All 83-On

4 Cylinder K & W Engines (built after 10-81) 82

Ford Motor Co.: 4 & 6 Cylinder 98, 122,
140, 171 Eng. 73-On

Honda: 4 Cylinder Prelude 83-On

Mazda: 4 Cylinder All 72-On

Pontiac: 4 Cylinder 1.8 (Diesel) 83-On

Volkswagen: 4 Cylinder All

(Water Cooled Engine) 74-On

090-042



Zinc

Thread: M18-1.5

Hex: 19mm

Length Under Head: 12mm

Washer Head O.D.: 29mm

Fits the following applications:

Chrysler: All imports 70-On

Renault: Le Car 79-76 Toyota:

All 75-On

090-039



(Nissan : 11128-69200)

Nissan 1986-71

Thread: M16.4-1.33 O.S. Hex: 19mm

Nissan: All (Exc. Sentra, Stanza &

Pulsar with FWD62-On

Renault: Fuego & Le Car 80-On

(Nissan : 11128-U8000)

090-054



Zinc

(Subaru: 807016160, 803916010;

Toyota: SU003-02194)

Thread: M16-1.5

Hex :14mm

Washer Head O.D.: 24mm Fits the

following applications: Subaru:

Legacy & Outback 2.5L

Scion: FR-S 2.0L 2013

090-088



12mm x 1.50

Premium (Long Body)

BMW 83-14,

MERCEDES-BENZ 82-14

090-114



(CHRYSLER: 4429215)

Thread: M18-1.5 Hex : 19mm

Magnetic Drain Plug **TOYOTA:**

90341-18057 MITSUBISHI:

MB569390 FORD :

E3TZ 7A010-A

090-167



Volvo #982547-0

Thread: 18mm - 1.50

Hex: 17mm

Volvo 2019-92

Volvo: 978138-6

Volvo: 986833

SUMP PLUG

090-082



Oil Drain Plug Oversize

M14-1.50 S.O.

Head Size 18Mm

090-062



(CHRYSLER: 3723687)

Rubber Differential Plug

Chrysler 2019-78,

Mitsubishi 2008-06

52070428AA: CHRYSLER

5252504: CHRYSLER

5252504AB: CHRYSLER

090-043



(Magnetic)

1/2" Standard

, GMC 83-96

FORD TRUCK Diesel 83-89

090-080

"PAN SAVER" UNIVERSAL OIL DRAIN PLUG

Solves the problem of oil pans with threads stripped beyond repair.

- This unique plug combines a tight rubber seal with a sturdy metal "Toggle-Lock".
- Great applications: works on most vehicles with 1/2"- 3/4" (12mm - 18mm) diameter holes.
- CAUTION: Not for use on Honda or VW Products.

Make sure threaded bolt will not contact any internal parts before installation. Bolt enters oil pan 1-7/8". Not a permanent solution.

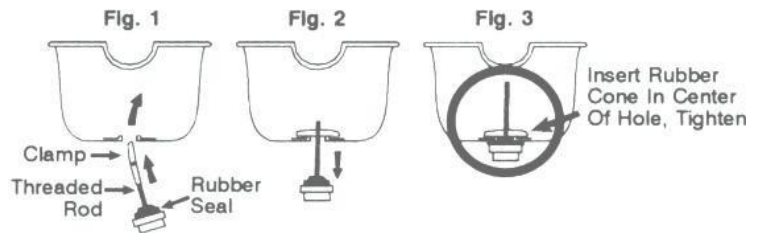

090-214

(BMW: 11-13-7-605-018)

Black Plastic

Plastic Oil Drain Plug

With Rubber Gasket

Thread: M24-1.5 x 11mm

Top Head Diameter: 36mm

Internal Hex Drive: 10mm

Fits the following applications:

BMW: 228i, 320i, 328i, 428i, 528i, X1

& Z4 2014 - On



090-090

(VW: 06L-103-801)

Black Plastic

Plastic Oil Drain Plug

Head Diameter: 23mm

(with Screw Driver Slot)

Overall Height: 20mm

With Installed Rubber O-Ring

Fits the following applications:

Audi: A3 & S3 and Volkswagen Golf

& GTI 2015 - On



OIL DRAIN PLUGS

090-946



(Mercedes-Benz: 0029902017)

Black Plastic

Plastic Oil Drain Plug

With Rubber Gasket

Fits the following applications:

2016 Mercedes-Benz C63 AMG S

2016 Mercedes-Benz G550

2014-2016 Mercedes-Benz S550

097-826.1



KX6Z6730B

Ford Drain Plug Yellow Plastic with

Rubber Gasket

Fits the following applications:

Ford 2018 F-150

064-740



19116852

Stainless Steel

Battery Terminal Replacement T-Block

Audi 2006-99, Cadillac 2014-07, ,

Chevrolet 2014-07,

GMC 2014-07

Saturn 2010-08

Volkswagen 2006-99

090-180



Universal Oil Drain Pl

5/8 In., Head Size N/A

Universal Replacement

090-057



Oil Drain Plug Universa

1/2 In., Head Size N/A

Universal Replacement

090-000



(TRL1000400)

Thread: M16

LAND ROVER DISCOVERY 2 TD5 ENGINE SUMP PLUG

Land Rover Sump Plug

Land Rover Defender TD5, (1998-2006)

Land Rover Discovery 2 TD5, (1998-2004)

090-211



(GM:55568037)

Thread: M14-1.5

Hex: 10mm

Fits the following applications:

Chevrolet: Cruze & Volt 2010 - On

Buick 2019-13

Cadillac 2016-14,

Chevrolet 2019-11

090-019



3/8"-18NPT

Drain Plug Plain Finish

Square Head Counter Sunk Pipe Plug

090-008



(948187-0)

Zinc

Thread: 3/4"-16

Fits the following applications:

Volvo: 4 Cylinder

OIL DRAIN PLUGS

090-001

(Mazda: FS50-21-249 - Drain Plug,

Oil Drain Plug with Gasket

Thread: M14-1.5

Drive: 8mm Allen

Head Diameter: 22mm

Length Under Head: 16mm

Fits the following applications:

Mazda: 3, 6 & CX-5 2012 - On; RX-8 2011 - 09



090-951

Thread: M20-1.5

Hex: 17mm

Length Under Head: 15mm

Washer Head O.D.: 27mm

Fits the following M20-1.5 applications:

Chevrolet Truck: Luv 82-75

Honda: All exc. Prelude 73-On

Subaru: All 79-On



090-173

18mm x 1.50

Square oil drain plug

9.75mm Female

Molded Rubber

DODGE TRUCK(6) 5.9L 02-06, (8)6.7L 08-12



097-826

(FORD:FT4Z-6730-A)

(FORD:BC3Z6730A)

Yellow Plastic with

Fits the following applications:

Ford 2019-15, Ford 2011,

Lincoln 2019-16



T10549

Removal Install Tool

Oil Pan Drain Plug Screw Removal Install Tool For T10549

VAG VW Audi Skoda Seat

For professional loosening and tightening of plastic drain plugs

Suitable for oil drain plugs in plastic oil pans, built in:

Suitable for oil drain plugs in plastic oil pans, built in:

Seat; Alhambra, Leon, Toledo

Skoda; Octavia, Rapid, Superb, Yeti

VW; Beetle, Caddy, CC, Golf, Jetta, Passat, Polo, Scirocco, Sharan, Tiguan, Toura

To be used as OEM - T10549

Pro-Range.



OIL & TRANSMISSION DRAIN PLUGS

Rubber Expansion Frost Plug Assortment

13 Sizes Fitting Holes from 3/4" to 2 3/8



The assortment contains one each of the following plug sizes:

- 0311:** 1" Rubber Expansion Plug - Size Range 1" to 1 1/8" - 25mm to 28mm
 - 1311:** 1 1/4" Rubber Expansion Plug - Size Range 1 1/4" to 1 3/8" - 31mm to 34mm
 - 2311:** 1 3/8" Rubber Expansion Plug - Size Range 1 3/8" to 1 1/2" - 34mm to 38mm
 - 3311:** 1 1/2" Rubber Expansion Plug - Size Range 1 1/2" to 1 5/8" - 38mm to 41mm
 - 4311:** 1 5/8" Rubber Expansion Plug - Size Range 1 5/8" to 1 3/4" - 41mm to 44mm
 - 5311:** 1 3/4" Rubber Expansion Plug - Size Range 1 3/4" to 1 7/8" - 44mm to 47mm
 - 6311:** 1 7/8" Rubber Expansion Plug - Size Range 1 7/8" to 2" - 47mm to 50mm
 - 7311:** 2" Rubber Expansion Plug - Size Range 2" to 2-1/8" - 50mm to 53mm
 - 8311:** 3/4" Rubber Expansion Plug - Size Range 3/4" to 7/8" - 19mm to 22mm
 - 9311:** 7/8" Rubber Expansion Plug - Size Range 7/8" to 1" - 22mm to 25mm
 - 10311:** 1 1/8" Rubber Expansion Plug - Size Range 1 1/8" to 1 1/4" - 28mm to 31mm
 - 11311:** 2 1/8" Rubber Expansion Plug - Size Range 2-1/8" to 2-1/4" - 53mm to 57mm
 - 12311:** 2 1/4" Rubber Expansion Plug - Size Range 2-1/4" to 2-3/8" - 57mm to 60mm
-